

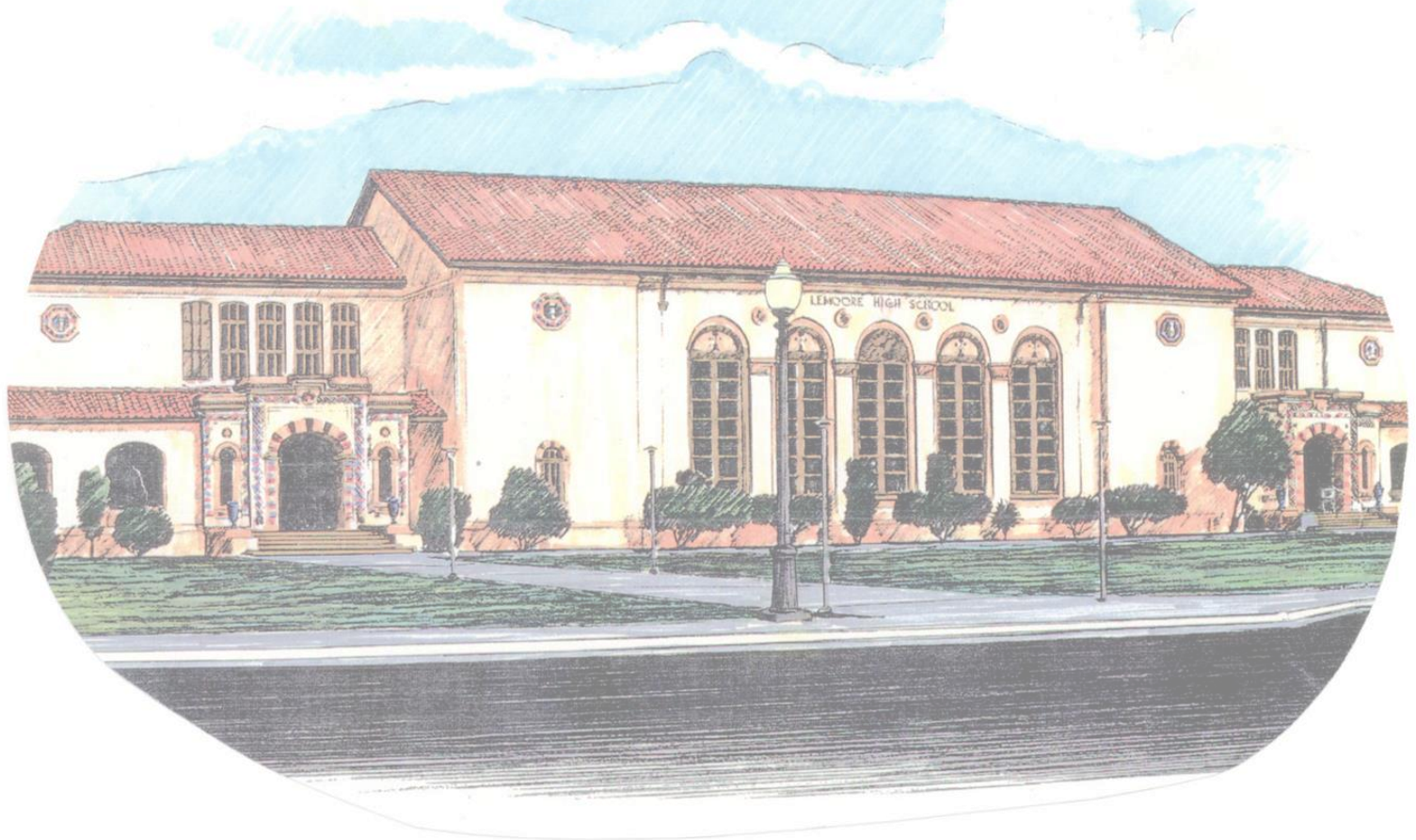

TETER

Lemoore UHSD

Master Plan Overview



ARCHITECTS
ENGINEERS
CONNECTED

- **Facilities Assessment**
 - Met with Architect staff and completed a site evaluation
- **Community Involvement**
 - Held Community Meeting and Sent out Survey
- **Financial**
 - Reviewed Local and State Funding Options
- **Planning**
 - Developed Prioritized Facility Project List
- **Final Master Plan**
 - Presented Draft Master Plan to Board

Initial Campus Review – Site Evaluation

- Campus is a good size and has maintained its historical integrity
- Campus lacks organization, landscaping and shaded student gathering spaces
- Corridor roofs in need of repair
- Infrastructure issues: sewer clogs, underground water pipes failing and power distribution problems
- In need of a technology upgrade and completion of EMS integration
- Pool is in need of replastering and lacks shade for seating
- Ag farm lacks classroom and lab space
- Stadium restrooms, concessions and path of travel in need of ADA upgrades
- Stadium circulation problems
- Lack of defined fire and maintenance access roads



Initial Campus Review - Buildings

- Science labs are outdated and one additional lab is needed
- Library needs technology upgrade and modernization
- Home economics building is outdated and not accessible
- Wood shop and auto shop are in need of renovations
- Small gym will be difficult and costly to renovate due to building configuration and hazardous materials
- Auditorium seating is outdated



Initial Campus Review

- Site: Secure campus with adequate seating and shade
- Infrastructure issues: No integration into EMS system, no common bell or PA system
- No permanent buildings, all portables – pests get under buildings
- Graphics arts classroom is not big enough for silk screening
- Admin, Registrar/Counseling department is split between two buildings





TETER

Survey Results

Community Meeting

1. Technology
2. Science Labs
3. CTE
4. Library
5. Jamison
5. Stadium
7. Landscape
8. Ag Farm
9. EMS
10. Access Roads

Campus Distribution

1. Technology
2. Stadium
3. Landscape
4. Science Labs
5. Pool Replaster
6. Ag Farm
7. EMS
8. CTE
9. Library
10. Access Roads

Survey Monkey

1. Technology
2. Science Labs
3. CTE
4. Library
5. Ag Farm
6. Landscape
7. EMS
8. Stadium
9. Auditorium
10. Jamison



TETER

Funding Summary

■ Developer Fee Fund	\$832,222
■ Capital Reserve Fund	\$1,159,869
■ 2016 Bond	\$24,000,000
■ Modernization Eligibility	\$0
■ New Construction Eligibility	\$6,000,000
Based on preliminary estimates from the State	
■ <u>Prop 39 Funding</u>	<u>\$94,219</u>
■ Total	\$32,863,310

LEMOORE HIGH SCHOOL

101 East Bush Street, Lemoore, CA





Campus Vision



RECOMMENDED IMPROVEMENTS

- A** Jamison Reconfiguration
- B** Data Infrastructure Upgrade
- C** Library Remodel
- D** Science Building Remodel
- E** Demolish Home Ec and small gym. Construct new academic building and plaza in their place.
- F** New Athletic building and renovation of existing weight room
- G** Remodel T-5 for new engineering classrooms
- H** New hardscape and landscaping in courtyards (two phases)
- I** Stadium Renovation
- J** Complete integration of EMS
- K** Relocate classes 50 and 51 to buildings relocated from JHS to farm and provide Ag Fabrication and Design in buildings 50 and 51
- L** Abate lead & repaint Main building
- M** Re-plaster pool, new shade structure
- N** Re-pave parking lot (two phases)
- O** New service road

LEGEND

-  Major renovation: new cabinets, finishes, plumbing fixtures and electrical layout
-  Minor renovation: paint, flooring and tackboard
-  New Structure
-  Building to be demolished/ portable building

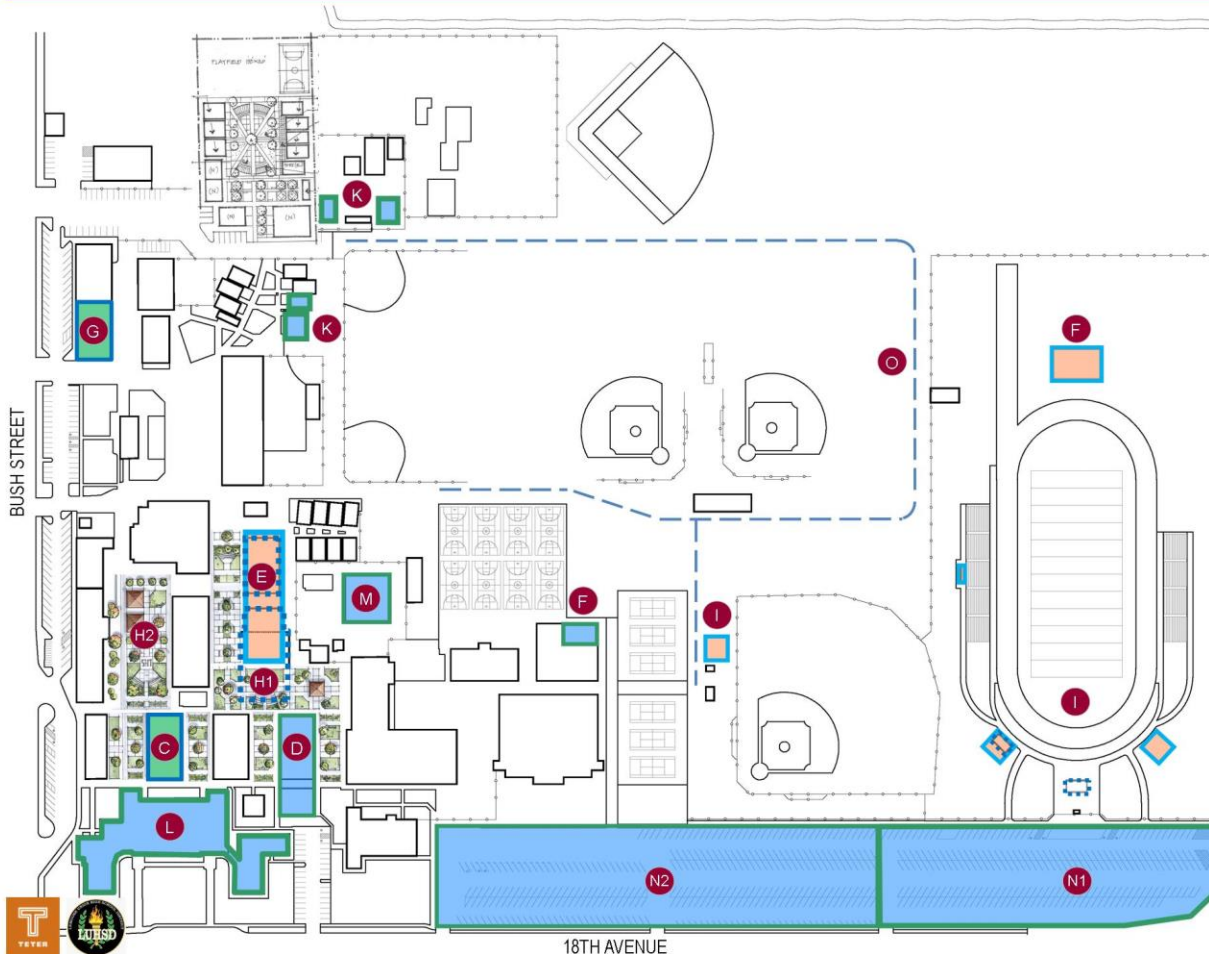



TETER

First Priority Projects

■ New Athletic Building	\$2,004,199
■ T-5 Remodel	\$551,109
■ Jamison Renovation	\$4,487,615
■ New Academic Building	\$6,523,830
■ Landscape Improvements (Phase 1)	\$1,153,530
■ Stadium Renovation	\$2,427,644
■ Data Infrastructure Upgrade	\$938,811
■ Pool Replaster and Shade	\$543,761
■ Repave Stadium Parking Lot (Phase 1)	\$918,515
■ EMS Expansion	\$94,219
■ Science Building Remodel	\$1,353,523
■ <u>Paint Main Building</u>	<u>\$364,913</u>
■ Sub-Total	\$21,361,668

****Construction costs have been escalated for project budgets and inflation to time of estimated construction. Final project costs depend upon the actual scope of work and schedule of construction.**



TETER

Second Priority Projects

■ Library Remodel	\$1,940,986
■ Ag Farm Classrooms	\$470,804
■ Repave Stadium Parking Lot (Phase 2)	\$1,399,177
■ New Service Road	\$214,342
■ <u>Landscape Improvements (Phase 2)</u>	<u>\$1,538,301</u>
■ Sub-Total	\$5,563,610
■ <u>First Priority Sub-Total</u>	<u>\$21,361,668</u>
■ Grand Total	\$26,925,278



TETER

Campus Vision

LEMOORE HIGH SCHOOL

101 East Bush Street, Lemoore, CA



Campus Vision

RECOMMENDED IMPROVEMENTS

- A** Jamison Reconfiguration
- B** Data Infrastructure Upgrade
- C** Library Remodel
- D** Science Building Remodel
- E** Demolish Home Ec and small gym. Construct new academic building and plaza in their place.
- F** New Athletic building and renovation of existing weight room
- G** Remodel T-5 for new engineering classrooms
- H** New hardscape and landscaping in courtyards (two phases)
- I** Stadium Renovation
- J** Complete integration of EMS
- K** Relocate classes 50 and 51 to buildings relocated from JHS to farm and provide Ag Fabrication and Design in buildings 50 and 51
- L** Abate lead & repaint Main building
- M** Re-plaster pool, new shade structure
- N** Re-pave parking lot (two phases)
- O** New service road

LEGEND

- Major renovation: new cabinets, finishes, plumbing fixtures and electrical layout
- Minor renovation: paint, flooring and tackboard
- New Structure
- Building to be demolished/ portable building

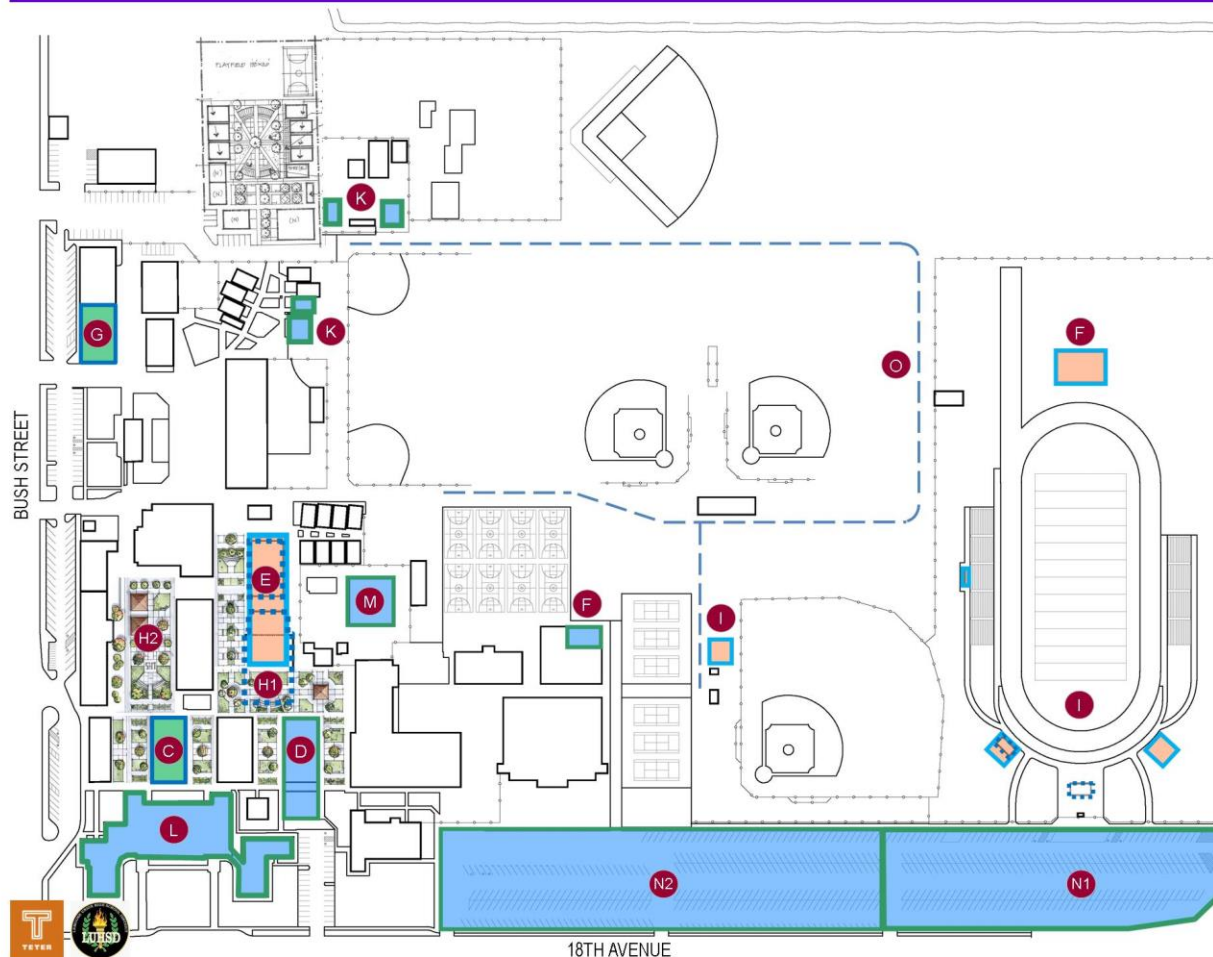

ARCHITECTS
ENGINEERS
CONNECTED





TETER

Jamison Renovation

Description of Project

- New permanent modular Administration building, Multi-Purpose building and (2) CTE Classrooms
- Relocate 5 existing portable classrooms to improve layout
- New shade structures and student area

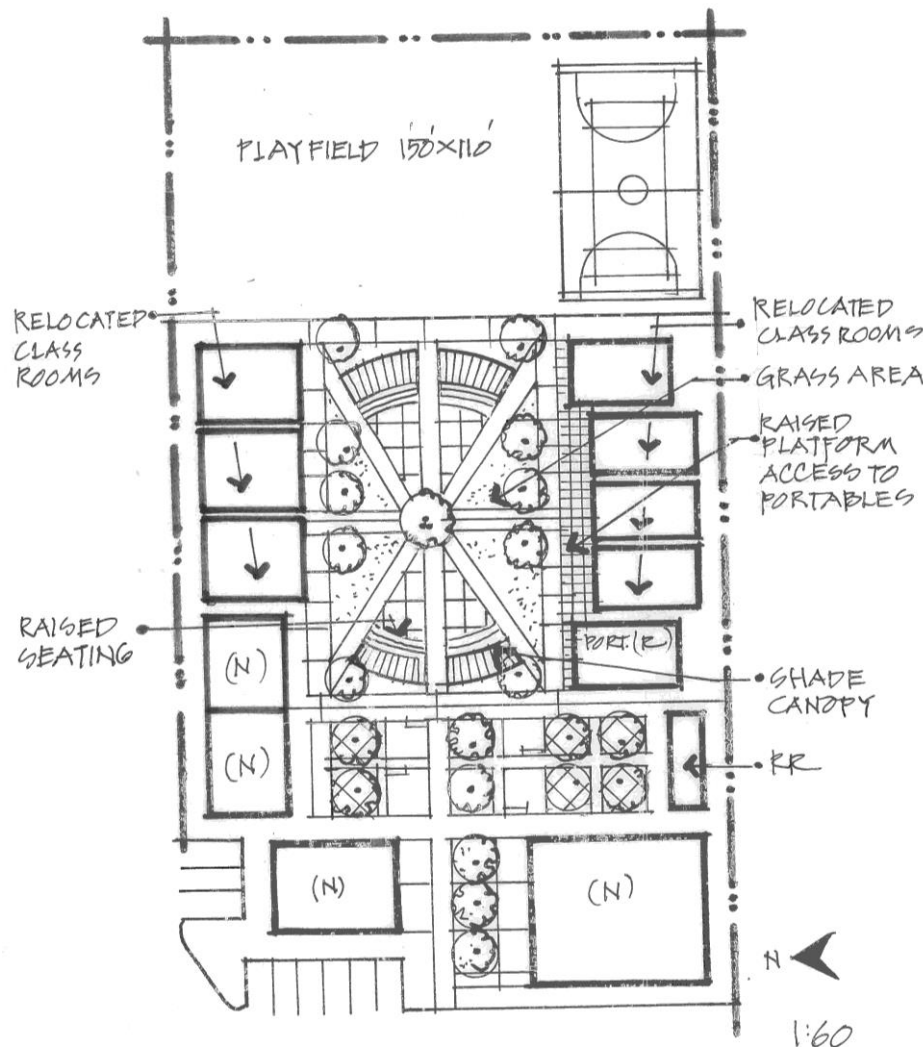

REVISED JAMISON LAYOUT

(E) JAMISON SITE 71,000SF
REVISED SITE 76,000SF



TETER

Data Infrastructure Upgrade

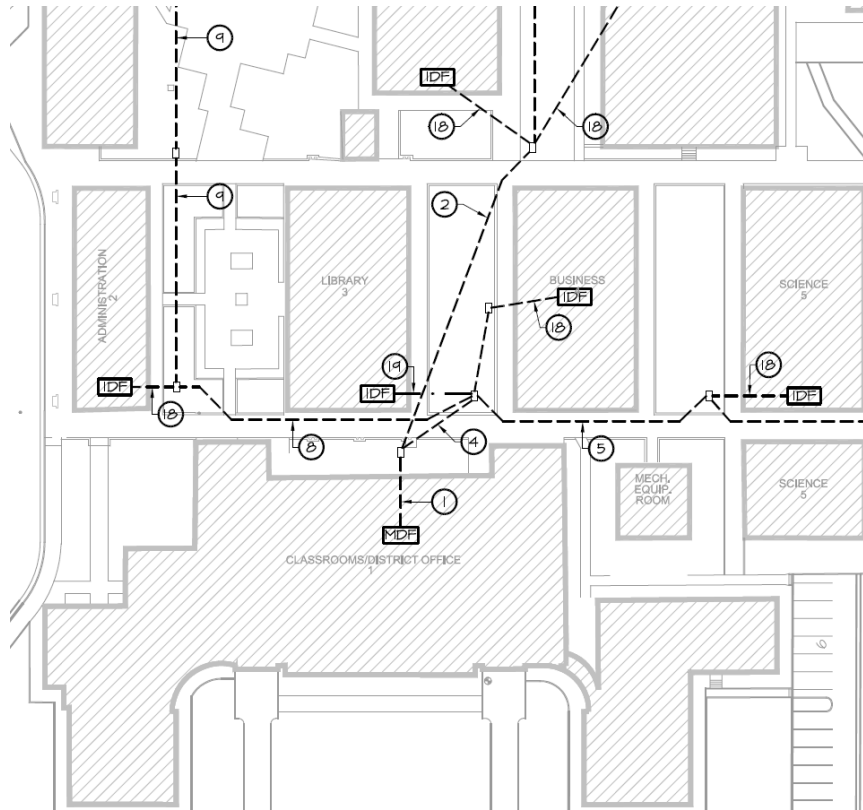

Description of Project

- Phase 1 includes upgrades to horizontal cabling within buildings, new data outlets, replacement/ relocation/ reconfiguration of IDF cabinets
- Phase 2 includes new site fiber optic backbone



TETER

Library Remodel



Description of Project

- Major renovation includes upgrades to HVAC, lighting and finishes
- Charging Stations, Additional student work space



TETER

Science Building Remodel

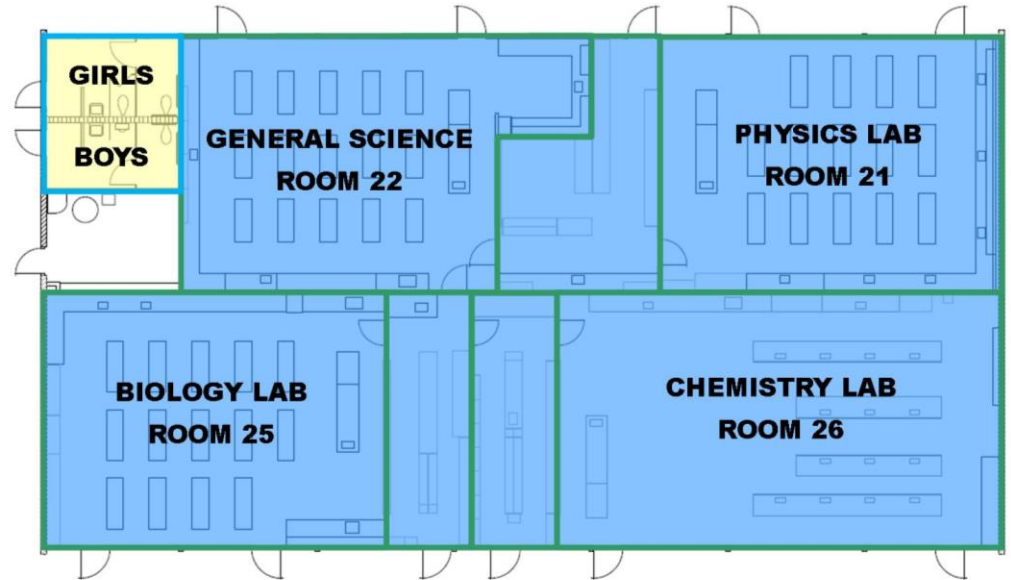
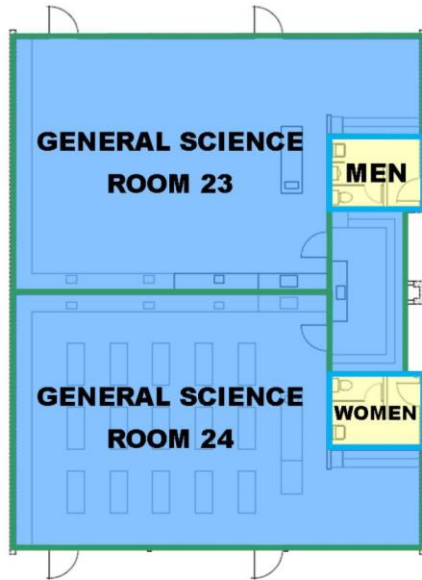

SCIENCE ACCOMMODATIONS

	Science Lab/CR	Science CR	Science Lab	Classroom
Existing	1 (Room 26)	5 (Rooms 21-25)	0	1 (Room 18)
Future	3 (Locate 2 new Lab/CR's in new academic building)	5 (Rooms 21-25)	0	1 (Room 18)

RECOMMENDED IMPROVEMENTS

- A** Update Science Classrooms 21-25 and storage/ work rooms
- B** Update Science Lab/Classroom 26
- C** Accessibility upgrades in the toilet rooms

LEGEND

-  Accessibility renovation: necessary replacement/relocation of plumbing fixtures and/or toilet room accessories to meet current code requirements
-  Minor renovation: paint, flooring and tackboard



TETER

New Academic Building

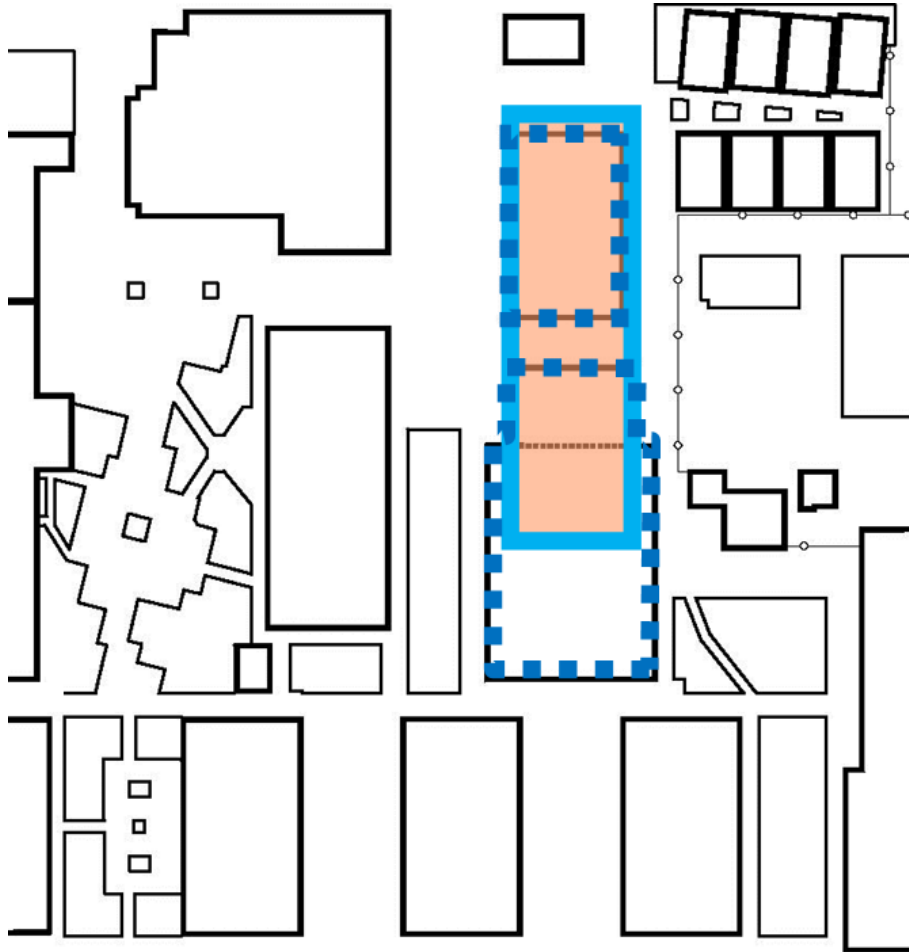

Description of Project

- Replaces Home Ec building and Small Gym (Accessibility/Asbestos/Lead Paint Issues)
- Build a new permanent modular Academic building
 - 8 classrooms
 - 4 classroom/labs
 - 1 Choir Room

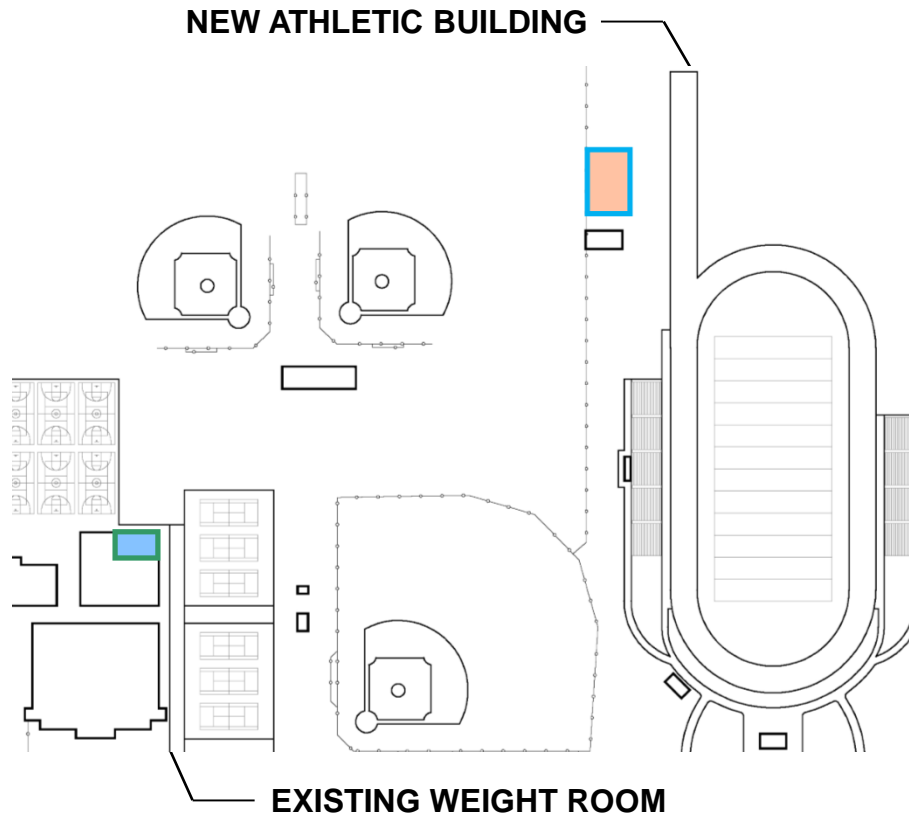

Description of Project

- Minor renovation to existing weight room includes an upgrade to finishes
- Build a new permanent modular athletic building
 - weight room
 - cross fit room
 - coach's office
 - restrooms



TETER

T-5 Remodel



Description of Project

- Convert T-5 into (2) engineering classrooms
- Major renovation includes upgrades to HVAC, lighting and finishes



TETER

Landscape/ Hardscape Improvements

Phase 1

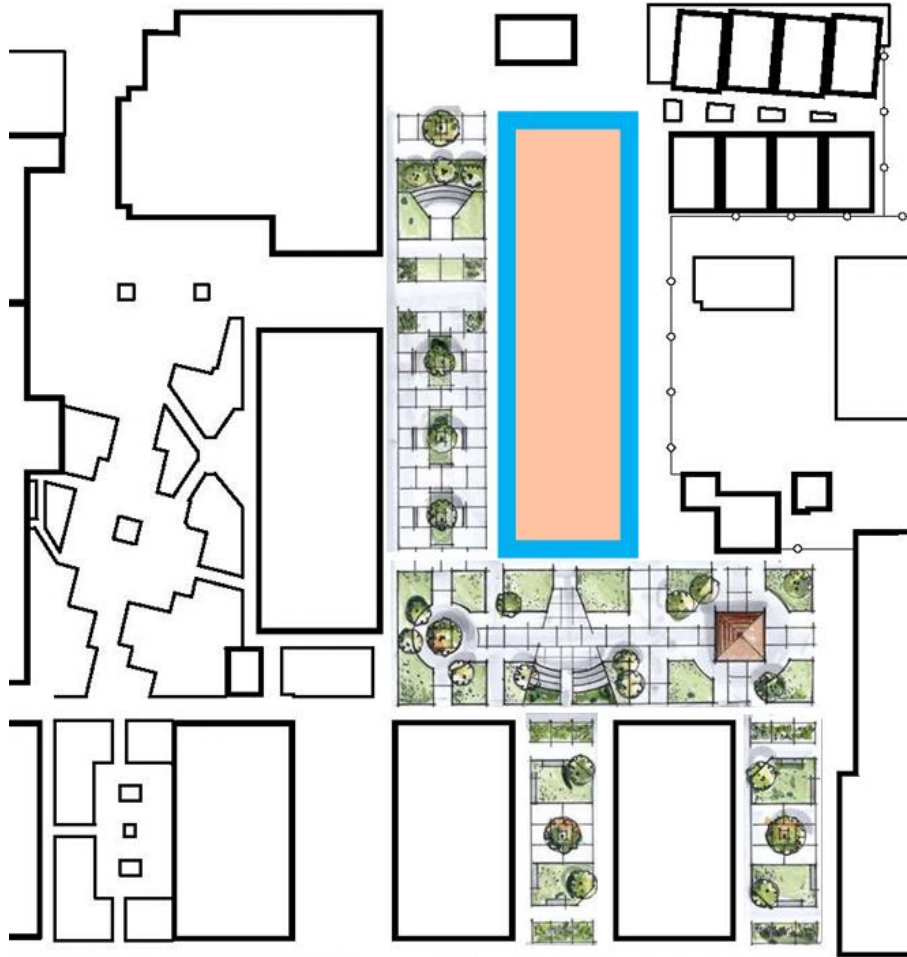

Description of Project

- Demolish existing landscape and hardscape adjacent to new academic building and on either side of the science building
- New landscaping, concrete flatwork, shade structures, seating and outdoor instructional space
- Reroof and repair covered walk ways

Landscape/ Hardscape Improvements

Phase 2



Description of Project

- Demolish existing landscape and hardscape adjacent to presentation center and on either side of the library
- New landscaping, concrete flatwork, shade structures, seating and outdoor instructional space
- Reroof and repair covered walk ways

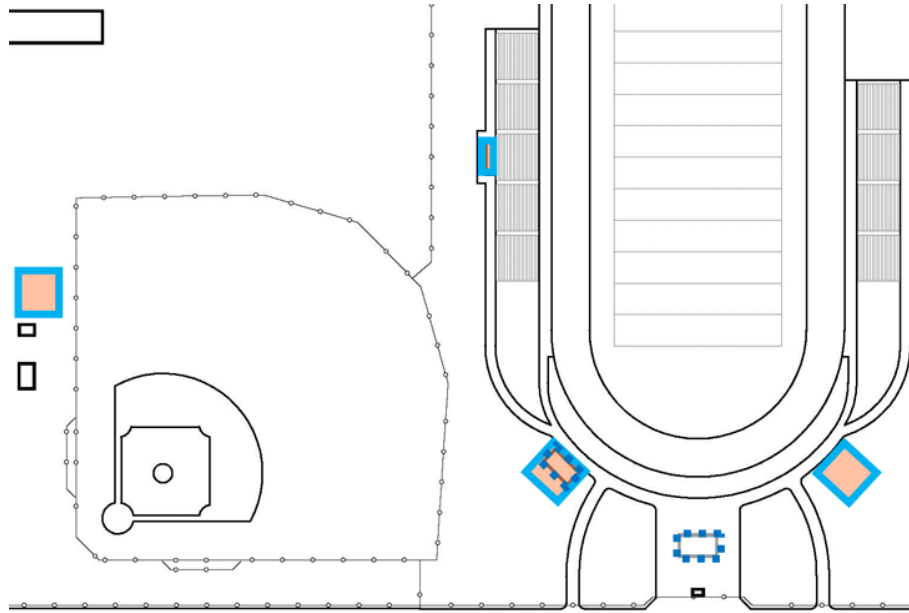

Description of Project

- Demolish existing concessions, restrooms, and press box
- Modify existing ramps to make them accessible
- Modify top row of seats to provide accessible seats
- Build a new press box and (3) new restroom/ concessions buildings
Two in Stadium; One at Varsity Baseball Field



TETER

Complete EMS Integration

Description of Project

- Expand EMS controls to units in the following locations: District Office, Principal's office, Technology office, Main Gym Coaches office, Small Gym rooms 40 and 41, Swimming Pool office, Team Tradition, NJROTC building, County Special Education building, T1-T5 and Ag building



Description of Project

- Relocate 2 portables from JHS to Ag Farm
- Relocate the classes that take place in rooms 50 and 51 to Ag Farm classrooms
- Provide new Ag Design and Fabrication classes in rooms 50 and 51

Main Building Lead Abatement and Painting



Description of Project

- Lead abatement of exterior paint
- Repaint exterior of Main building

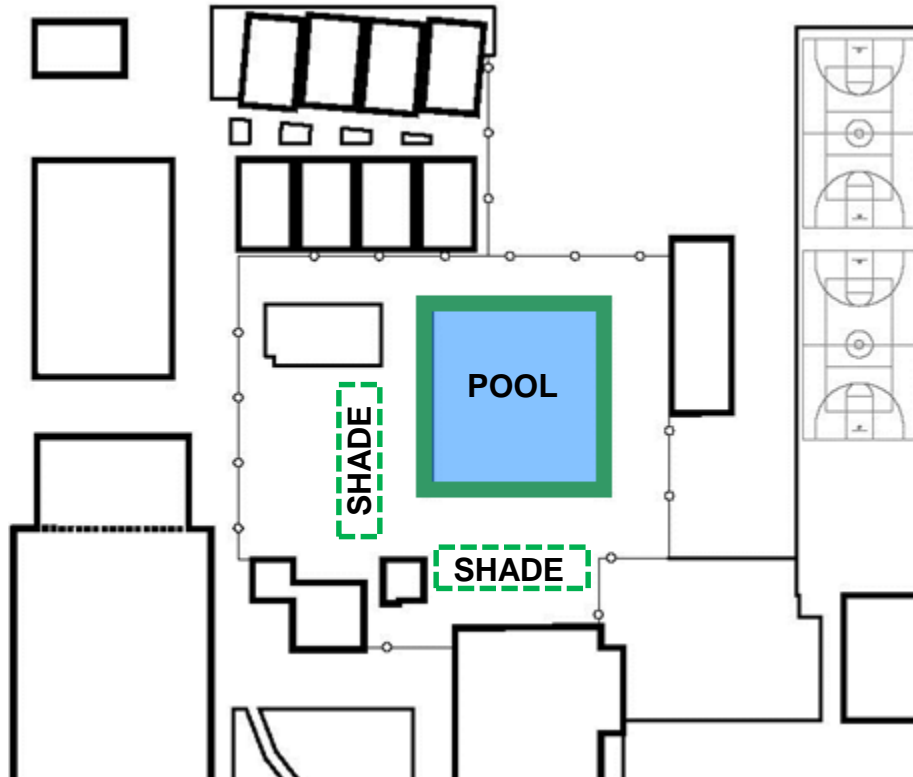

Description of Project

- Re-plaster existing pool
- (2) new shade structures over seating



TETER

Tennis Court Expansion

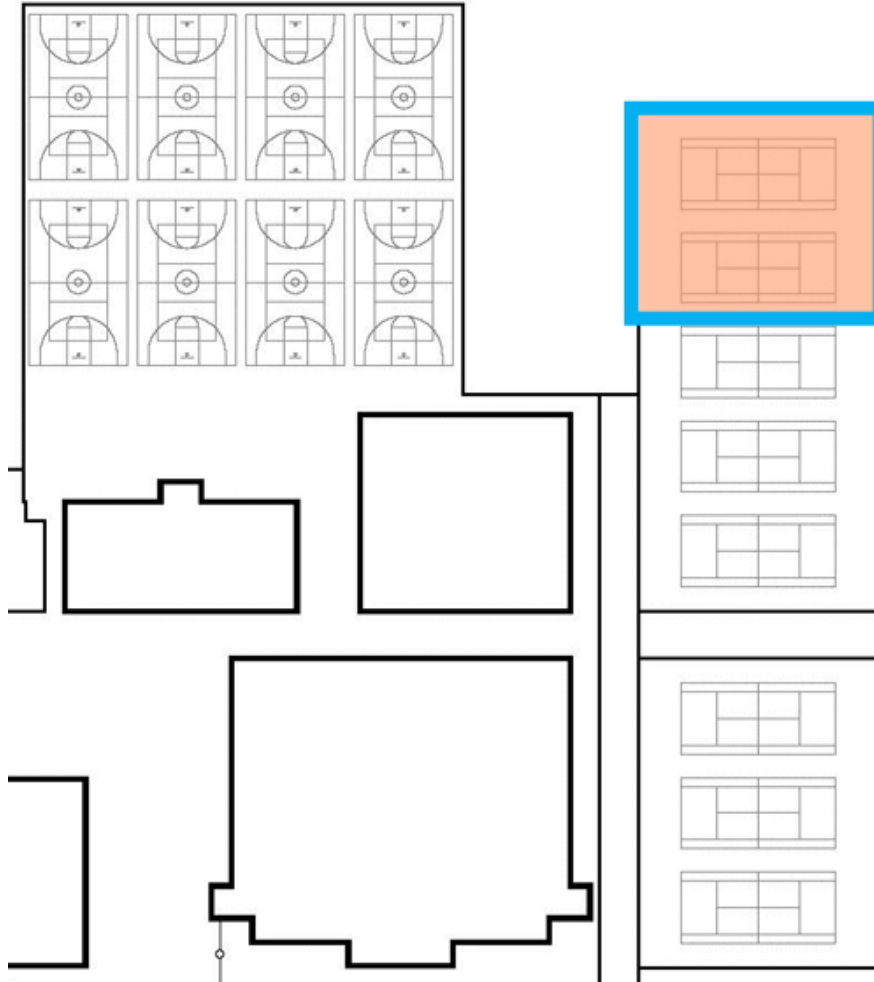

a) Description of Project

- (2) new tennis courts
- Court lighting for new courts and (3) east most existing courts



TETER

Re-Pave Parking Lot Phase 1

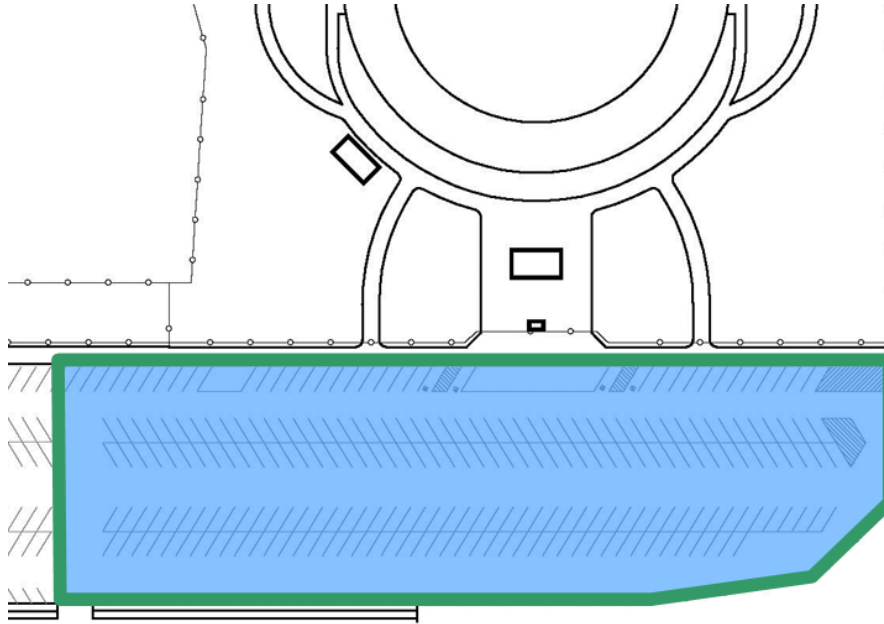

Description of Project

- Re-pave existing stadium parking lot



TETER

Re-Pave Parking Lot Phase 2

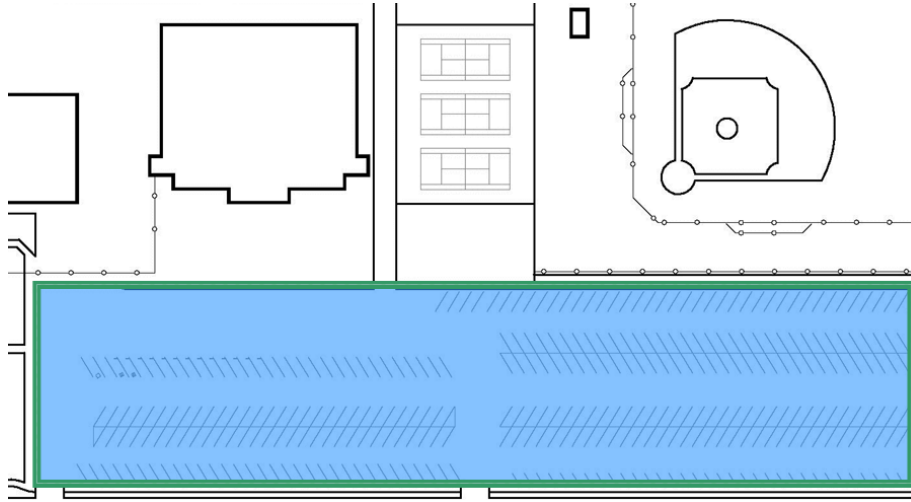

Description of Project

- Re-pave existing stadium parking lot



TETER

New Service Road

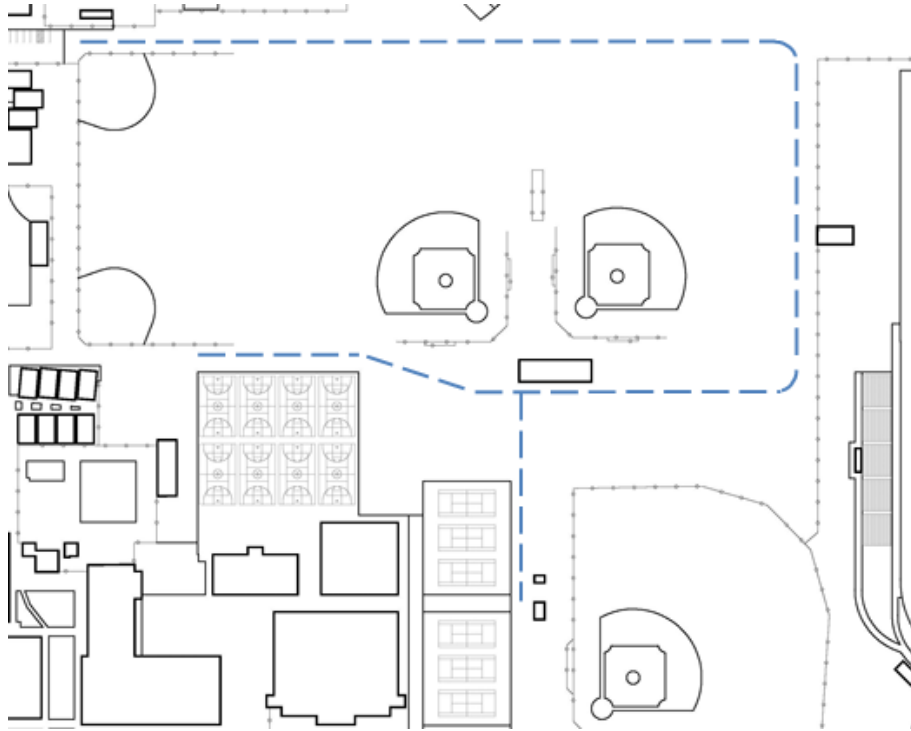

Description of Project

- New 10' wide paved service road

November 2016 Bond

- **Lemoore Union High School District last went out for a bond in 1997 for \$10 million to build the Event Center and it will be paid off in 2021-22**
- **Eligible for \$24 million bond and costs to the voters are estimated to be \$27.50 per \$100,000 assessed value of their property based on 2017-18 values**
- **Prop 39 now allows us to pass at 55%**
- **Board voted in favor of going out for a Bond on June 9, 2016**